

Specifications

Media	: Air filtered, lubricated or dry
Ports	: 1/8" NPT or 5/32" plug-in tube
Operating Pressure	: 0 to 150 PSI
Temperature	: 20°F to 150°F
Operators	: Mechanical and manual
Operating Force	: 2 to 5 lbs. (see table)
Orifice	: 3.5 mm (0.14")
Flow Coefficient	: CV = 0.28

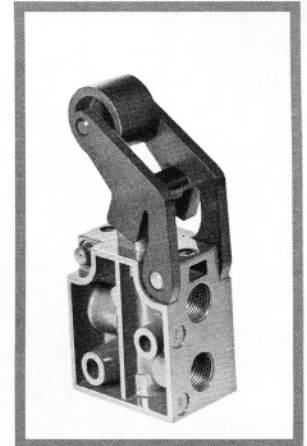





Construction

Body: zinc diecasting
Internal parts: Delrin
Sealing: Nitrile (NBR)

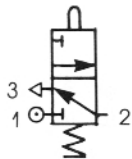
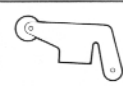

The versatile Model 310 is a manual or mechanical micro-valve. Six different heads may be used on the same valve base; palm button, mushroom palm, toggle switch, roller cam, or one-way trip for mechanical actuation. All these heads are readily interchangeable.

Selection Chart

Function	Type	Description	Force Required (lbs.)	Model Numbers	
				Operator Only	Complete Valve*
Normally Closed 1 = Pressure 2 = Outlet 3 = Exhaust 	—	Valve Alone 5/32" Plug-in	5 lbs.	—	310 90 002
	—	Valve Alone 1/8" NPT	5 lbs.	—	310 90 003
		Lever Roller (Delrin)	2 lbs.	881 31 001	310 00 018
		One Way Trip (Delrin)	2 lbs.	881 31 002	310 00 019
		Push Button 40 mm	5 lbs.	881 31 007	310 00 022
		Mushroom 60 mm	5 lbs.	881 31 004	310 00 023
		Toggle Lever	—	881 31 003	310 00 024
		Lever Roller (Metal)	2 lbs.	881 31 005	310 00 025

*Complete valve numbers indicated are assembled using 1/8 NPT version number 310 90 003.

Dimensions and Weights

Valve alone
Weight: 0.22 lbs.

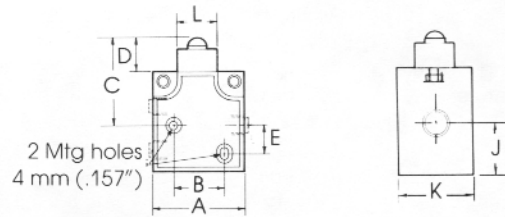
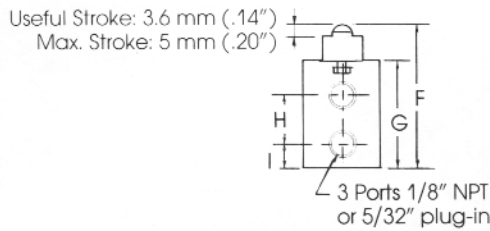

Lever roller Delrin
Weight: 0.22 lbs.

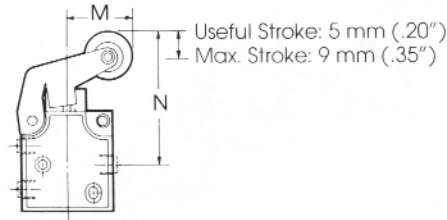

Valve operation NC

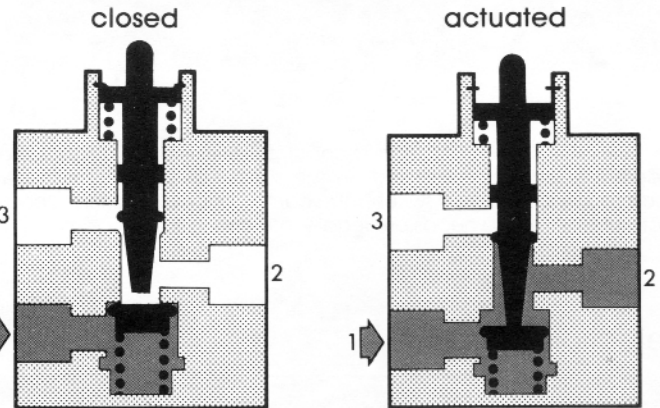

Mushroom
60 mm
Weight: 0.26

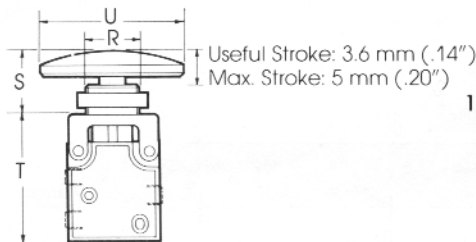

Push button
40 mm
Weight 0.32 lbs.

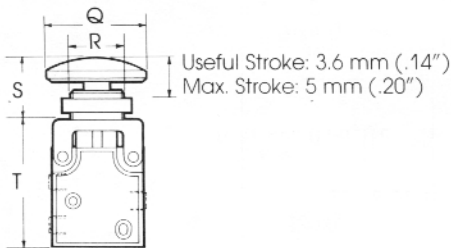

One way trip Delrin
Weight: 0.24 lbs.

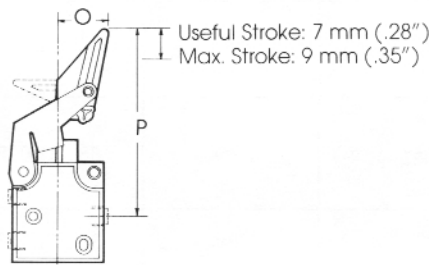

Lever roller metal
Weight: 0.24 lbs.

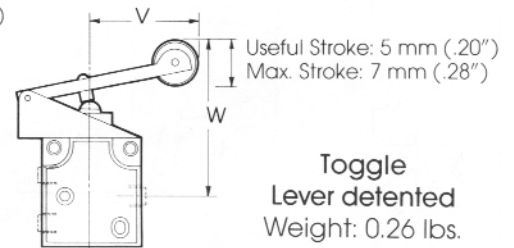

Toggle
Lever detented
Weight: 0.26 lbs.

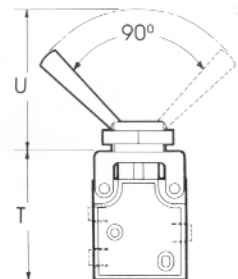

Dimensions

	A	B	C	D	E	F	G	H	I	J	K	L
inch	1.38	.75	1.34	.51	.43	2.09	1.57	.71	.35	.75	.98	.59
mm	35	19	34	13	11	53	40	18	9	19	25	15
	M	N	O	P	Q	R	S	T	U	V	W	
inch	.83	2.80	.71	3.24	1.57	.87	1.02	2.01	2.36	1.46	2.23	
mm	21	71	18	82	40	22	26	51	60	37	59	